

KENTUCKY HISTORIC RESOURCES INVENTORY

Site No. Me 178

1. Historic Name(s) <u>John Me Lee house</u>		22. ADD/County <u>Bluegrass, Mercer 084</u>	
Original Owner <u>John Me Lee</u>		23. U.S.G.S. Quadrant (15'/75') <u>Cornishville</u> G.I.S. Mod. <input type="checkbox"/>	
2. Present Name		24. UTM Reference Zone <u>16</u> Easting <u>681670</u> Northing <u>4188870</u>	
3. Location <u>1/2 mi N of Jackson Rd., 1/4 mi W of 127 on E side Salt River</u>		25. Coordinate Accuracy <input type="checkbox"/>	
4. Owner's Name <u>Jamie C. Clark 734-9587</u>		26. Prehistoric Site <input type="checkbox"/> Object <input type="checkbox"/> Historic Site <input type="checkbox"/> Structure <input type="checkbox"/> Building <input checked="" type="checkbox"/> Other <input type="checkbox"/>	
5. Owner's Address <u>Route 5 Box 485 Harrodsburg, Ky. 40330</u>		27. National Register District Name: <input type="checkbox"/>	
6. Open to Public Yes <input type="checkbox"/> No <input checked="" type="checkbox"/>	7. Visible from road Yes <input checked="" type="checkbox"/> No <input type="checkbox"/>	8. Ownership Private <input checked="" type="checkbox"/> Local <input type="checkbox"/> State <input type="checkbox"/> Federal <input type="checkbox"/>	
9. Local Contact/Organization		28. Significance Evaluation <input type="checkbox"/>	
10. Site Plan with North Arrow <u>see attached boundary form</u>		29. Status National Landmark <input type="checkbox"/> Date _____ National Register <input type="checkbox"/> Landmark Certificate <input type="checkbox"/> Kentucky Survey <input checked="" type="checkbox"/> <u>1970</u> Local Landmark <input checked="" type="checkbox"/> <u>1969</u> HABS/HAER <input type="checkbox"/>	
11. Architect		30. Historic Theme Primary <u>Architecture</u> <input type="checkbox"/> <u>C</u> Secondary <u>Settlement</u> <input type="checkbox"/> <u>R</u> Other <input type="checkbox"/>	
12. Builder		31. Endangered Yes <input type="checkbox"/> No <input checked="" type="checkbox"/>	
13. Date <u>ca 1790</u> A. <input checked="" type="checkbox"/> B. <input type="checkbox"/>		32. Preservation Project Status <input type="checkbox"/>	
14. Style A. <u>Federal</u> <input checked="" type="checkbox"/> B. <input type="checkbox"/>		Actual Cost in \$1,000s <input type="checkbox"/>	
15. Original Use <u>residence</u> <input checked="" type="checkbox"/>		33. ATTACH PHOTO <u>in attached envelope</u>	
16. Present use <u>vacant</u>			
17. Condition <u>good</u> <input checked="" type="checkbox"/>			
18. Description <u>2 story, hall parlor dry stone house, 2 bay 2nd floor, three bays on 1st floor front. Masonry has wider range of stone sizes than usual - like flag pattern, well done, but w. rough bousairs, no keps and walls w.o. regular courses. (over)</u>		No. Stories <u>2</u> <input checked="" type="checkbox"/> Single Pile <input checked="" type="checkbox"/> NA <input type="checkbox"/> Double Pile <input type="checkbox"/> Floor Plan <u>hall parlor</u> <input checked="" type="checkbox"/> Structural Fabric <u>Stone</u> A. <input checked="" type="checkbox"/> B. <input type="checkbox"/> Decorative Fabric <u>—</u> A. <input type="checkbox"/> B. <input type="checkbox"/> Roof Form <u>gable</u>	
19. History <u>Built by Rev. soldier John Me Lee (b. Ireland 1730) who came to Ky w the McAfee Co. in 1775 from Batelourt Co. Va. Had 1000 acre tract surveyed for him in 1773; he and family survived hard winter of 1779-80 at McAfee</u>		Roll No. _____ Picture No. _____ Direction _____	
20. Significance <u>Good example of very early simple stone house (w finely detailed ell) Built by early settler in the region.</u>		34. Prepared by: <u>C.M. Wooley</u>	
21. Source of Information <u>18. exterior inspection only interior description from KHC file 19. 1982 NR nomination form</u>		35. Organization _____ 36. Date <u>1982</u> 37. Revision Dates _____ 38. Staff Review _____	

18. cont.:

no tool marks, original pointing  
fled (being redone w staple pointing);  
interior end chimneys; top plate visible (photo 3)  
on end; 1 small attic window, N end only;  
no cellar.

Interior has winding stair in SW corner;  
some better, some panel, doors; wrought iron  
hinges, some strap, some HL; had board  
partition walls. Large fireplace in hall  
has adged oak lintel.

Roof extended on S gable end. Window  
frames and sash changed - have narrow  
mitered corner frames. Front doorway has  
narrow beaded frame, not pegged, ogive trim  
(early 19th C.)

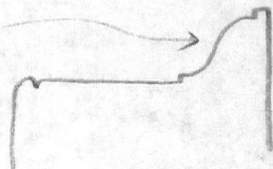

One story ell on W side stone house  
(ca. 1825) has elaborate Federal woodwork  
of Matthew Lowry type: rosette corner blocks, (photo 4)  
fluted pilasters - inside and out; chair rail;  
sunburst mantle w bedding & rope carving.

On N end of house is a pegged, hewn frame  
of a single room w exterior stone chimney; no (photo 1)  
doorway into stone house.

House had a 1 story shed roof porch w chamfered  
posts across E side (now removed). New frame  
addition built on W side beside early wing.

In NE corner of yard is a post cellar with  
frame grainary above. (dairy)

House possibly originally faced the river (having  
rear porch), but is now oriented toward the E. It  
is built on nearly level land w gentle slope to river  
on the W and branch on the N.

owner's kind note,  
because fewer  
windows on W.

19. cont.:

Stetson. Was co-founder of New Providence  
Presbyterian Church, where he was buried in 1810.

VERBAL BOUNDARY DESCRIPTION & JUSTIFICATION

Beginning at A at a fence corner in the NE corner of the yard, thence S w fence 150 ft to B, thence at right angle to fence 180 ft W to C, thence parallel to A-B 150 ft N to D, thence with the fence E 180 ft to the beginning, containing the stone house and dairy - about 2/3 acre.

SKETCH MAP OF SITE SHOWING BOUNDARIES AND KEY BUILDINGS AND FEATURES WITH NORTH ARROW.

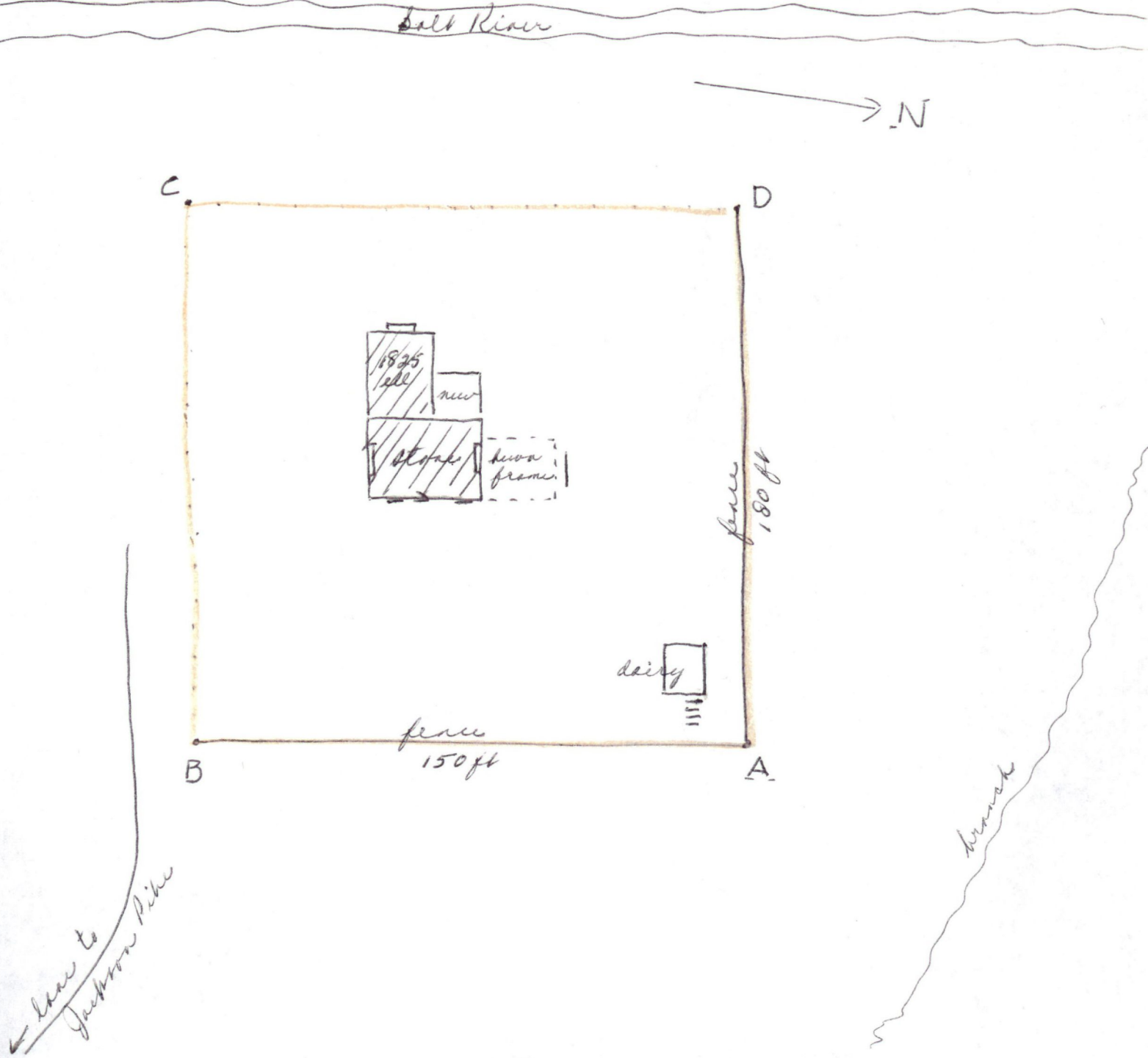

United States Department of the Interior  
National Park Service

National Register of Historic Places  
Inventory—Nomination Form

For NPS use only

received

date entered

Continuation sheet

Item number

Page 9 of 13

Multiple Resource Area  
Thematic Group

Name Early Stone Buildings of Central Kentucky Thematic Resources

State Kentucky

Nomination/Type of Review

Date/Signature

81. McAfee, James, House

Entered in the  
National Register

for Keeper

Melvin Byers 6/23/83

Attest

82. McGee, John, House

Entered in the  
National Register

for Keeper

Melvin Byers 6/23/83

Attest

83. Shaker Wist Lot Farm

Entered in the  
National Register

for Keeper

Melvin Byers 6/23/83

Attest

84. Stone Quarters on Burgin Road

Entered in the  
National Register

for Keeper

Melvin Byers 6/23/83

Attest

201  
Montgomery 85. Bondurant House

Substantive Review

for Keeper

Accept Patrick Andrews 6/23/83

Attest

Nicholas 86. Riggs, Erasmus, House

Entered in the  
National Register

for Keeper

Melvin Byers 6/23/83

Attest

87. Stone Barn on Brushy Creek

Entered in the  
National Register

for Keeper

Melvin Byers 6/23/83

Attest

88. Thompson, John Henry, House

Entered in the  
National Register

for Keeper

Melvin Byers 6/23/83

Attest

Woodford 89. Alexander Plantation House

Entered in the  
National Register

for Keeper

Melvin Byers 6/23/83

Attest

206  
90. Allen, John, House

Entered in the  
National Register

for Keeper

Melvin Byers 6/23/83

Attest

NATIONAL REGISTER OF HISTORIC PLACES

EVALUATION / RETURN SHE

United States Department of the Interior  
National Park Service

McGee, John, House (Early Stone Buildings of  
Central Kentucky TR)  
Mercer County  
KENTUCKY

Working No. MAY 10 1983  
Fed. Reg. Date: 2-7-84  
Date Due: 6/9/83 6/24/83  
Action:  ACCEPT 6/23/83  
 RETURN  
 REJECT  
Entered in the \_\_\_\_\_  
National Register \_\_\_\_\_  
Federal Agency: \_\_\_\_\_

- resubmission
- nomination by person or local government
- owner objection
- appeal

Substantive Review:  sample  request  appeal  NR decision

Reviewer's comments:

Recom./Criteria \_\_\_\_\_  
Reviewer \_\_\_\_\_  
Discipline \_\_\_\_\_  
Date \_\_\_\_\_  
see continuation sheet

Nomination returned for:  technical corrections cited below  
 substantive reasons discussed below

1. Name

2. Location

3. Classification

Category \_\_\_\_\_ Ownership \_\_\_\_\_ Status \_\_\_\_\_ Present Use \_\_\_\_\_  
Public Acquisition \_\_\_\_\_ Accessible \_\_\_\_\_

4. Owner of Property

5. Location of Legal Description

6. Representation in Existing Surveys

has this property been determined eligible?  yes  no

7. Description

Condition \_\_\_\_\_ Check one \_\_\_\_\_ Check one \_\_\_\_\_  
 excellent  deteriorated  unaltered  original site  
 good  ruins  altered  moved date \_\_\_\_\_  
 fair  unspoiled

Describe the present and original (if known) physical appearance

- summary paragraph
- completeness
- clarity
- alterations/integrity
- dates
- boundary selection

---

## **8. Significance**

Period \_\_\_\_\_ Areas of Significance—Check and justify below

Specific dates \_\_\_\_\_ Builder/Architect \_\_\_\_\_

Statement of Significance (in one paragraph)

- \_\_\_\_\_ summary paragraph
- \_\_\_\_\_ completeness
- \_\_\_\_\_ clarity
- \_\_\_\_\_ applicable criteria
- \_\_\_\_\_ justification of areas checked
- \_\_\_\_\_ relating significance to the resource
- \_\_\_\_\_ context
- \_\_\_\_\_ relationship of integrity to significance
- \_\_\_\_\_ justification of exception
- \_\_\_\_\_ other

---

## **9. Major Bibliographical References**

---

### **10. Geographical Data**

Acresage of nominated property \_\_\_\_\_

Quadrangle name \_\_\_\_\_

UMT References \_\_\_\_\_

Verbal boundary description and justification \_\_\_\_\_

---

### **11. Form Prepared By**

---

### **12. State Historic Preservation Officer Certification**

The evaluated significance of this property within the state is:

\_\_\_\_\_ national \_\_\_\_\_ state \_\_\_\_\_ local

State Historic Preservation Officer signature \_\_\_\_\_

title \_\_\_\_\_ date \_\_\_\_\_

---

### **13. Other**

- \_\_\_\_\_ Maps
- \_\_\_\_\_ Photographs
- \_\_\_\_\_ Other

Questions concerning this nomination may be directed to \_\_\_\_\_

Signed \_\_\_\_\_ Date \_\_\_\_\_ Phone: 202 272-3504

Comments for any item may be continued on an attached sheet











Please refer to the map in the  
Multiple Property Cover Sheet  
for this property

Multiple Property Cover Sheet Reference Number: 64000214